

ADAMS COUNTY

APPLICATION for SLOW MOVING BUILDING / LARGE OBJECT PERMIT

A. Rules:

1. A slow moving building/large object is defined as a building or large object in excess of legal dimensions for width, length, height, or any combination thereof that must be moved at a slow speed, typically 30 mph or less.
2. The application for a permit to move a slow moving building/large object on a county road shall be made to the Highway Superintendent's Office a minimum of 5 days in advance of the date of the move to provide for review and approval.
3. An additional local permit may be required for moves on state or city roads. The applicant is responsible for contacting those local authorities.
4. The applicant must provide a certificate of insurance (ACCORD FORM) for public liability and property damage in an amount not less than \$1,000,000 to Adams County prior to the move. The certificate must state that 10 days notice will be given to the county before cancellation.
5. Adams County will require the mover or its' insurance company to reimburse the county for any damages to the road system or structures and incorrectly placed signs thereon by reason of the move and the mover shall pay the cost of expenses for inspection of the move by Adams County.

B. Selection of Routing:

1. The request needs to include the location of the building/large object to be moved and the final destination. It must also include what streets/county roads that will be used as part of the move. Application shall include city and county maps showing the exact location of the object.
2. The applicant shall explore all alternative routes before submitting an application. Failure to review alternate routes could delay the approval.
3. Applicant shall submit two pictures of the building/large object. Pictures shall show the width (end), length (side) and height of the building/large object.
4. Application shall include the name of owner and the mover with telephone numbers for both parties.
5. City, State and Utility Companies are to be contacted for appropriate permits as needed.
6. Local law enforcement is to be contacted for traffic control as needed.
7. County person on the permit shall be contacted 24 hours prior to the move and after the move is completed.

Please provide your actual axle spacing and axle weights and show the top view of your axle spacing below. Example is shown on back of page.

ACTUAL AXLE SPACING AND AXLE WEIGHTS

	Axle 1	Axle 2	Axle 3	Axle 4	Axle 5	Axle 6	Axle 7	Axle 8
Weight								
Spacing								

	Axle 9	Axle 10	Axle 11	Axle 12	Axle 13	Axle 14
Weight						
Spacing						

As per Nebraska Rev. Stat. §§48-436 to 48-442, we require the applicable power company to approve the proposed route prior to any approval by Adams County.

Local Power Company: _____

Reviewed & Approved by: _____

Date: _____

County Approval by: _____

Date: _____

AXLE SPACING AND WEIGHTS EXAMPLE ONLY:

Please provide your actual axle spacing and weights as well as the top view of the tire spacing as shown in the example below.

	Axle 1	Axle 2	Axle 3	Axle 4	Axle 5	Axle 6
Weight	12000	18000	18000	15000	15000	15000
Spacing	12'	5'	15'	5'	5'	

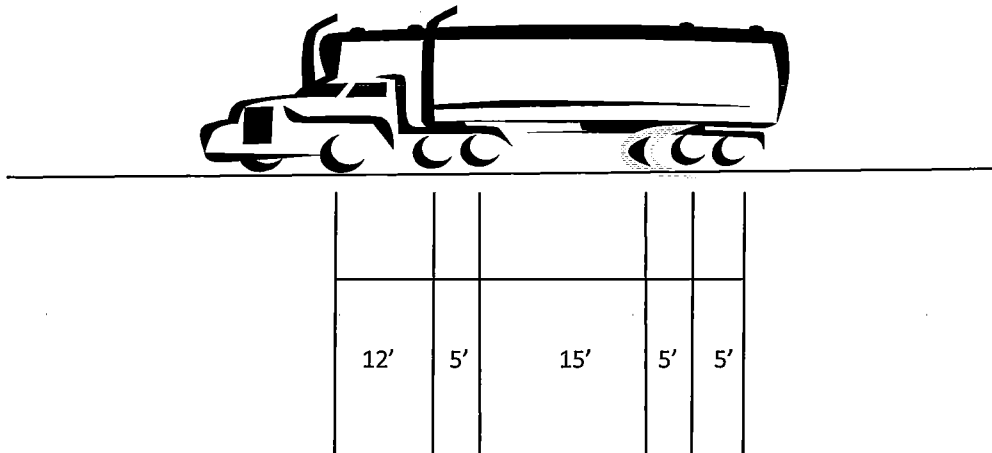

TOP VIEW – AXLE TIRE SPACING

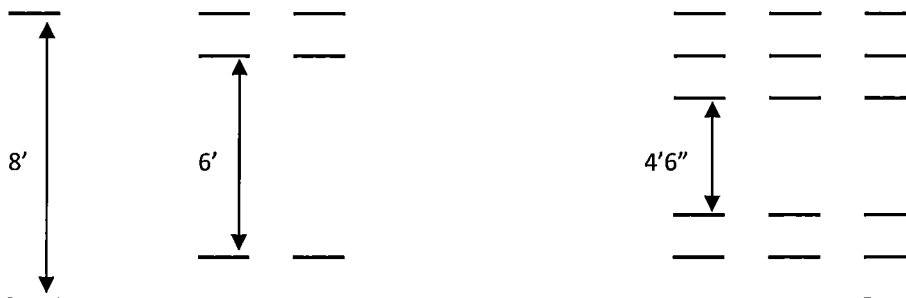

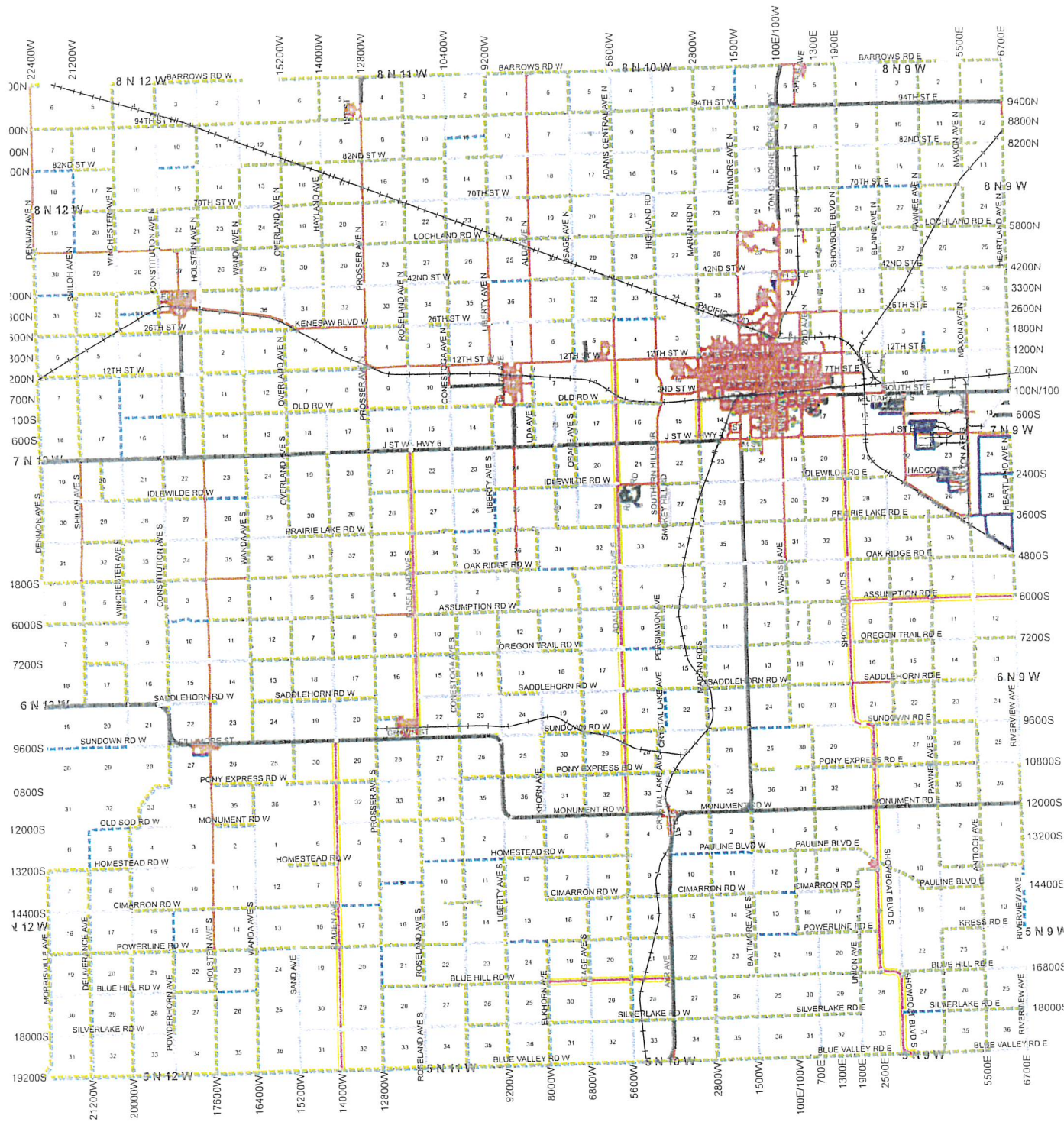

Roads	
	<all other values>
	GRAVEL
	HIGHWAY
	DORSURFACE
	MIN MAINT
	PAVED
	PRIVATE
	TOWNSHIP
	CONCRETE
	VILLAGE

